

Pan Head - Type I (Phillips) Combination Sltd - A, AB

TYPE I WITH SLOT

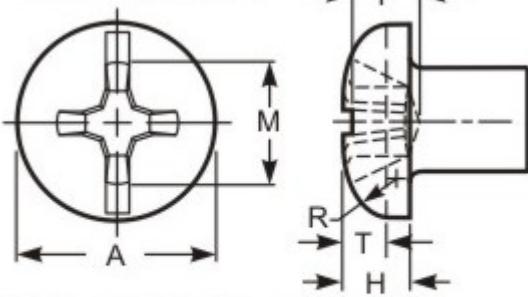

This type of recess has a large center opening, tapered wings, and blunt bottom, with all edges relieved or rounded. A slot runs parallel to one pair of recess wings.

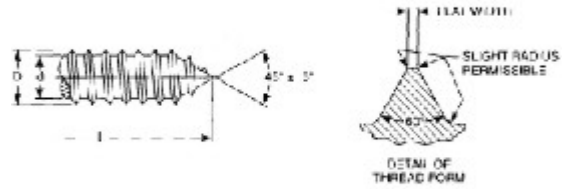

THREAD DATA		
Size: #8	Threads per in.: 18	Thread Class or Type: AB
Major Diameter: 0.1660 - 0.1590	Minor Dia Max/Min.: 0.122 - 0.116	Standard: ASME B18.6.3-2013
DIMENSIONAL DATA		
Type: Pan Head - Type I (Phillips) Combination Sltd - A, AB	Standard: ASME B18.6.3 - 2013	Nominal Diameter: 0.164
A - Head Diameter: 0.322 - 0.306	H - Head Height: 0.115 - 0.105	J - Slot Width: 0.054 - 0.045
T - Slot Depth: 0.058 - 0.041	Driver Size: 2	Penetration Depth: 0.097 - 0.071
Wobble: 12°	M - Ref. Recess Dim.: 0.175	L - Length: 1/2
Length Tolerance: ± 0.03		
PHYSICAL REQUIREMENTS		
Nominal: 0.164	Standard: ASME B18.6.3-2013, Type AB (carbon steel)	Typical Materials: carbon steel: 1018-1022
Test Plate Thickness in.: 0.0770 - 0.0730	Test Plate Hole Size in.: 0.1360	Torsional Strength, Min. (in.lbf): 39
Core Hardness: HRC 28 - 38	Case Hardness: HRC 45 Min.	Case Depth (in.): .009-.004
Ductility Test Angle: 10°	Straightness Factor: N/A	
FINISH DATA		
Finish: Zinc & Clear, non-hexavalent/Cr(VI) free - .0001"/ 3µm	K factor (ref. DIN 946): 0.22	Standard: ASTM F1941/F1941M-2016, Fe/Zn 3AN

¹ These torque values are based on K factors determined using DIN 946, tightening tension of 75% of the yield strength, and the calculation formula $T=KDP$. These values are advisory only. The torque for assembling critical joints should be determined and/or verified through actual experimentation by the user. The IFI is not responsible for any losses or claims resulting from the use of these values.² Calculated Pretension is equal to 75% of the bolt's yield strength achieved when using the indicated Tightening Torque.

