

Product Image



Die Cast Liquid Tite Connectors – 90° Insulated

Insulated die cast liquid tight connectors are used to connect metallic and non-metallic liquid tight conduit to a weatherproof outlet box and various other electrical enclosures.

Features:

- UL listed and CSA certified
- Zinc die cast
- Available insulated & non-insulated

Dimensional Data

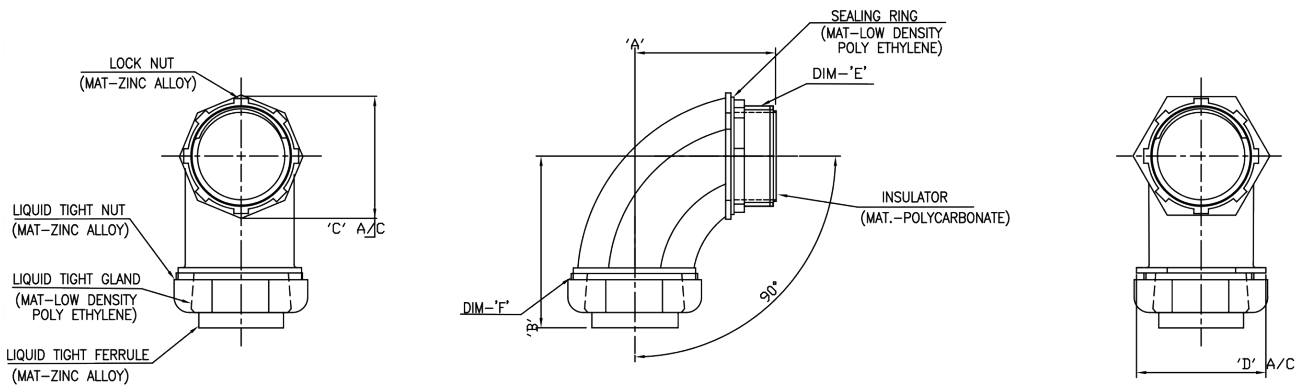

PN#	Size	"A" with Insulator	"B"	"C" A/C	"D" A/C	"E" NPT Thread	"F" UNF/UNS Thread
LT9038I	3/8"	40.10	46.54	-	-	1/2"	1-3/16" UNF
LT9050I	1/2"	40.10	46.54	-	-	1/2"	1-3/16" UNF
LT9075I	3/4"	42.55	50.28	-	-	3/4"	1-7/16" UNF
LT90100I	1"	62.23	72.92	-	-	1"	1-11/16" UNF
LT90125I	1-1/4"	60.60	74.69	57.06	-	1-1/4"	2-1/8" UNF
LT90150I	1-1/2"	65.50	75.87	65.36	-	1-1/2"	2-3/8" UNF
LT90200I	2"	73.00	83.13	79.45	-	2"	2-7/8" UNF
LT90250I	2-1/2"	94.00	116.77	102.95	103.13	2-1/2"	3-1/2" UNF
LT90300I	3"	106.00	131.27	122.84	122.84	3"	4" UNF
LT90350I	3-1/2"	109.00	153.00	138.00	138.00	3-1/2" NPSM	4-1/2"-14 UNS
LT90400I	4"	114.00	153.00	152.00	152.00	4" NPSM	5"-14 UNS

The liquid tight connectors were wet location tested and oil spray tested per UL514b per clause 8.7 and 8.17.6. Both tests simulates rain and falling liquids. Therefore, the liquid tight connectors are liquid tight, but are not submersible.