

# PRODUCT SPECIFICATIONS



## Product Image



## Die Cast Liquid Tite Connectors – Straight

Die cast liquid tight connectors are used to connect metallic and non-metallic liquid tight conduit to a box or enclosure.

Features:

- UL listed and CSA certified
- Zinc die cast
- Available insulated & non-insulated

## Dimensional Data

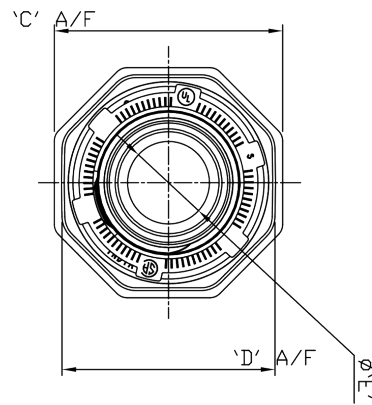
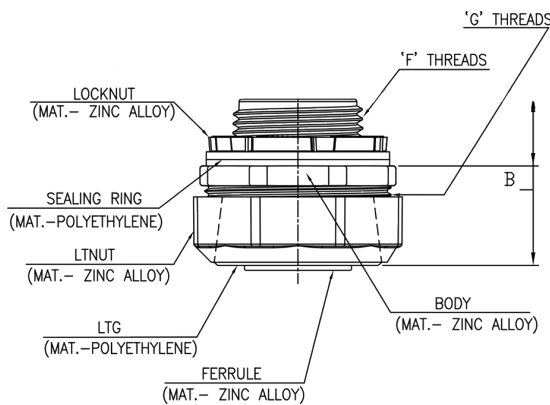

| PN#   | Size   | "A"<br>without Insulator | "B"   | "C"   | "D"   | "ØE"  | "F"<br>NPT Thread | "G"<br>UNEF Thread |
|-------|--------|--------------------------|-------|-------|-------|-------|-------------------|--------------------|
| LT38  | 3/8"   | 37.33                    | 13.34 | 32.55 | 30.50 | 10.60 | 1/2"              | 1-3/16"            |
| LT50  | 1/2"   | 36.32                    | 13.39 | 33.22 | 31.01 | 13.37 | 1/2"              | 1-3/16"            |
| LT75  | 3/4"   | 37.93                    | 13.00 | 40.00 | 37.60 | 18.18 | 3/4"              | 1-7/16"            |
| LT100 | 1"     | 47.00                    | 17.25 | 46.06 | 44.40 | 24.00 | 1"                | 1-11/16"           |
| LT125 | 1-1/4" | 50.26                    | 16.69 | 57.38 | 56.55 | 32.40 | 1-1/4"            | 2-1/8"             |
| LT150 | 1-1/2" | 49.60                    | 16.60 | 63.61 | 63.17 | 37.23 | 1-1/2"            | 2-3/8"             |
| LT200 | 2"     | 49.69                    | 16.70 | 76.14 | 75.58 | 48.28 | 2"                | 2-7/8"             |

The liquid tight connectors were wet location tested and oil spray tested per UL514b per clause 8.7 and 8.17.6 . Both tests simulates rain and falling liquids. Therefore, the liquid tight connectors are liquid tight, but are not submersible.