

Fillister Head - Type III (square socket) - A, AB

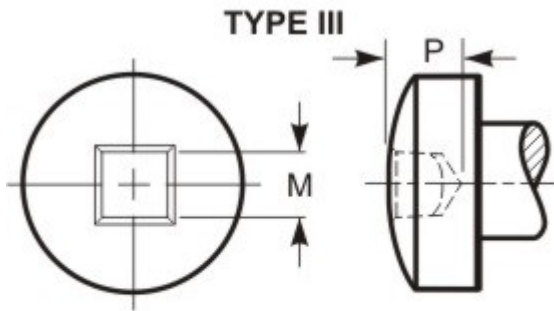

This type of recess has a square center opening, slightly tapered side walls, and a conical bottom with top edges relieved or rounded.

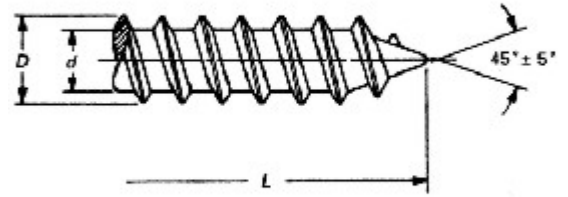

THREAD DATA		
Size: #6	Threads per in.: 18	Thread Class or Type: A
Major Diameter: 0.1410 - 0.1360	Minor Dia Max/Min.: 0.102 - 0.096	Standard: ASME B18.6.3-2013
DIMENSIONAL DATA		
Type: Fillister Head - Type III (square socket) - A, AB	Standard: ASME B18.6.3 - 2013	Nominal Diameter: 0.138
A - Head Diameter: 0.226 - 0.208	H - Head Height: 0.096 - 0.086	Driver Size: 1R
Penetration Depth: 0.065 - 0.050	Wobble: 3°	M - Ref. Recess Dim.: 0.091
O - Total Head Height: .132 - .111	L - Length: 1/2	Length Tolerance: ± 0.03
PHYSICAL REQUIREMENTS		
Nominal: 0.138	Standard: ASME B18.6.3-2013, Type A (carbon steel)	Typical Materials: carbon steel: 1018-1022
Test Plate Thickness in.: 0.0770 - 0.0730	Test Plate Hole Size in.: 0.1160	Torsional Strength, Min. (in.lbf): 24
Core Hardness: HRC 28 - 38	Case Hardness: HRC 45 Min.	Case Depth (in.): .007-.002
Ductility Test Angle: 10°	Straightness Factor: N/A	
FINISH DATA		
Finish: Zinc & Clear, non-hexavalent/Cr(VI) free - .0001"/ 3µm	K factor (ref. DIN 946): 0.22	Standard: ASTM F1941/F1941M-2016, Fe/Zn 3AN

² Calculated Pretension is equal to 75% of the bolt's yield strength achieved when using the indicated Tightening Torque.

