

## Pan Head - Type III (square socket) - A, AB

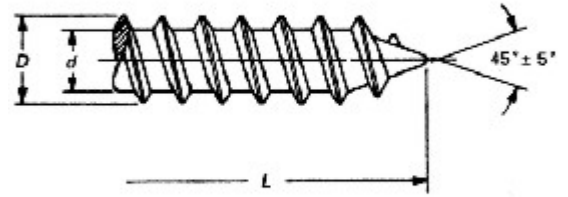
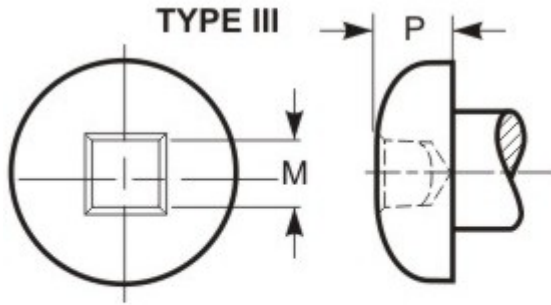

This type of recess has a square center opening, slightly tapered side walls, and a conical bottom with top edges relieved or rounded.

THREAD DATA		
<b>Size: #8</b>	<b>Threads per in.: 15</b>	<b>Thread Class or Type: A</b>
<b>Major Diameter: 0.1680 - 0.1620</b>	<b>Minor Dia Max/Min.: 0.123 - 0.116</b>	<b>Standard: ASME B18.6.3-2013</b>
DIMENSIONAL DATA		
<b>Type: Pan Head - Type III (square socket) - A, AB</b>	<b>Standard: ASME B18.6.3 - 2013</b>	<b>Nominal Diameter: 0.164</b>
<b>A - Head Diameter: 0.322 - 0.306</b>	<b>H - Head Height: 0.115 - 0.105</b>	<b>Driver Size: 2R</b>
<b>Penetration Depth: 0.075 - 0.060</b>	<b>Wobble: 3°</b>	<b>M – Ref. Recess Dim.: 0.112</b>
<b>L - Length: 1-1/4</b>	<b>Length Tolerance: ± 0.05</b>	
PHYSICAL REQUIREMENTS		
<b>Nominal: 0.164</b>	<b>Standard: ASME B18.6.3-2013, Type A (carbon steel)</b>	<b>Typical Materials: carbon steel: 1018-1022</b>
<b>Test Plate Thickness in.: 0.0770 - 0.0730</b>	<b>Test Plate Hole Size in.: 0.1360</b>	<b>Torsional Strength, Min. (in.lbf): 39</b>
<b>Core Hardness: HRC 28 - 38</b>	<b>Case Hardness: HRC 45 Min.</b>	<b>Case Depth (in.): .009-.004</b>
<b>Ductility Test Angle: 10°</b>	<b>Straightness Factor: N/A</b>	
FINISH DATA		
<b>Finish: Zinc &amp; Clear, non-hexavalent/Cr(VI) free - .0001"/ 3µm</b>	<b>K factor (ref. DIN 946): 0.22</b>	<b>Standard: ASTM F1941/F1941M-2016, Fe/Zn 3AN</b>

<sup>1</sup> These torque values are based on K factors determined using DIN 946, tightening tension of 75% of the yield strength, and the calculation formula  $T=KDP$ . These values are advisory only. The torque for assembling critical joints should be determined and/or verified through actual experimentation by the user. The IFI is not responsible for any losses or claims resulting from the use of these values. <sup>2</sup> Calculated Pretension is equal to 75% of the bolt's yield strength achieved when using the indicated Tightening Torque.

