

## Pan Head - Type III (square socket) - A, AB

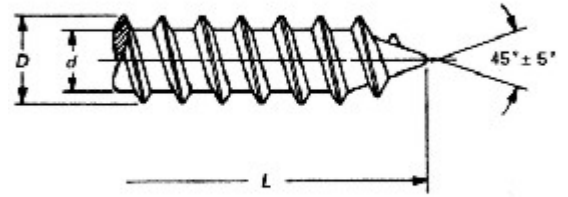
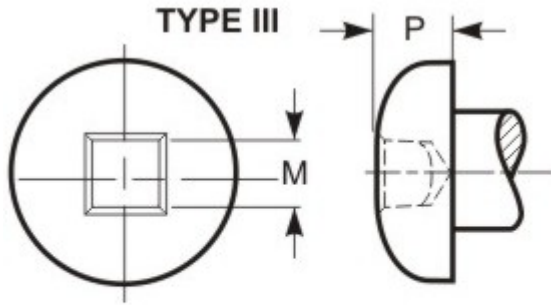

This type of recess has a square center opening, slightly tapered side walls, and a conical bottom with top edges relieved or rounded.

THREAD DATA		
<b>Size:</b> #8	<b>Threads per in.:</b> 15	<b>Thread Class or Type:</b> A
<b>Major Diameter:</b> 0.1680 - 0.1620	<b>Minor Dia Max/Min.:</b> 0.123 - 0.116	<b>Standard:</b> ASME B18.6.3-2013
DIMENSIONAL DATA		
<b>Type:</b> Pan Head - Type III (square socket) - A, AB	<b>Standard:</b> ASME B18.6.3 - 2013	<b>Nominal Diameter:</b> 0.164
<b>A - Head Diameter:</b> 0.322 - 0.306	<b>H - Head Height:</b> 0.115 - 0.105	<b>Driver Size:</b> 2R
<b>Penetration Depth:</b> 0.075 - 0.060	<b>Wobble:</b> 3°	<b>M – Ref. Recess Dim.:</b> 0.112
<b>L - Length:</b> 2-1/2	<b>Length Tolerance:</b> ± 0.05	
PHYSICAL REQUIREMENTS		
<b>Nominal:</b> 0.164	<b>Standard:</b> ASME B18.6.3-2013, Type A (carbon steel)	<b>Typical Materials:</b> carbon steel: 1018-1022
<b>Test Plate Thickness in.:</b> 0.0770 - 0.0730	<b>Test Plate Hole Size in.:</b> 0.1360	<b>Torsional Strength, Min. (in.lbf):</b> 39
<b>Core Hardness:</b> HRC 28 - 38	<b>Case Hardness:</b> HRC 45 Min.	<b>Case Depth (in.):</b> .009-.004
<b>Ductility Test Angle:</b> 10°	<b>Straightness Factor:</b> 0.015	
FINISH DATA		
<b>Finish:</b> Zinc & Clear, non-hexavalent/Cr(VI) free - .0001"/ 3µm	<b>K factor (ref. DIN 946):</b> 0.22	<b>Standard:</b> ASTM F1941/F1941M-2016, Fe/Zn 3AN

<sup>1</sup> These torque values are based on K factors determined using DIN 946, tightening tension of 75% of the yield strength, and the calculation formula T=KDP. These values are advisory only. The torque for assembling critical joints should be determined and/or verified through actual experimentation by the user. The IFI is not responsible for any losses or claims resulting from the use of these values. <sup>2</sup> Calculated Pretension is equal to 75% of the bolt's yield strength achieved when using the indicated Tightening Torque.

