

# Fillister Head - Type III (square socket) - A, AB

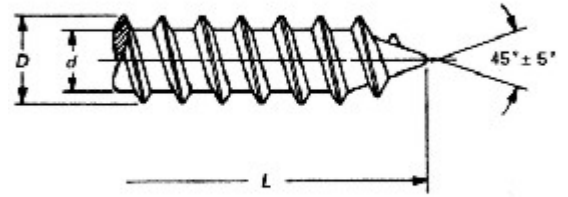
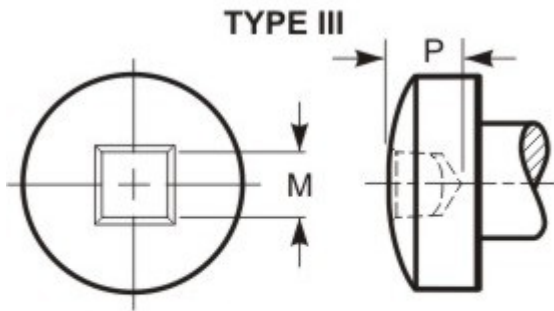

This type of recess has a square center opening, slightly tapered side walls, and a conical bottom with top edges relieved or rounded.

THREAD DATA		
Size: #10	Threads per in.: 12	Thread Class or Type: A
Major Diameter: 0.1940 - 0.1880	Minor Dia Max/Min.: 0.133 - 0.126	Standard: ASME B18.6.3-2013
DIMENSIONAL DATA		
Type: Fillister Head - Type III (square socket) - A, AB	Standard: ASME B18.6.3 - 2013	Nominal Diameter: 0.19
A - Head Diameter: 0.313 - 0.292	H - Head Height: 0.130 - 0.118	Driver Size: 2R
Penetration Depth: 0.075 - 0.060	Wobble: 3°	M - Ref. Recess Dim.: 0.112
O - Total Head Height: .180 -.156	L - Length: 2	Length Tolerance: ± 0.05
PHYSICAL REQUIREMENTS		
Nominal: 0.19	Standard: ASME B18.6.3-2013, Type A (18-8/304 Stainless)	Typical Materials: stainless steel: 304 (18-8)
Straightness Factor: 0.012		
FINISH DATA		
Finish: Zinc & Clear, non-hexavalent/Cr(VI) free - .0001" / 3µm	K factor (ref. DIN 946): 0.22	Standard: ASTM F1941/F1941M-2016, Fe/Zn 3AN

<sup>2</sup> Calculated Pretension is equal to 75% of the bolt's yield strength achieved when using the indicated Tightening Torque.

