

Flat Washers - Type A (Narrow) - SAE

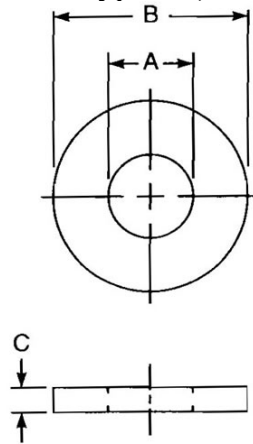

| DIMENSIONAL DATA | | |
|--|---|---|
| Type: Flat Washers - Type A (Narrow) - SAE | Standard: ASME B18.21.1-2009 | Size: #6 |
| Nominal: 0.138 | A - Inside Diameter: 0.164 - 0.151 | B - Outside Diameter: 0.390 - 0.370 |
| C - Thickness: 0.065 - 0.036 | | |
| MATERIAL DATA | | |
| Typical Material: Unhardened Carbon steel, 1006 | Hardness: no requirement | |
| FINISH DATA | | |
| Finish Type: Zinc & Clear, non-hexavalent/Cr(VI) free - .0001"/ 3µm | K factor (ref. DIN 946): 0.22 | RoHS/REACH Compliant: yes |
| Min.. Thickness (inches): 0.0001 | Min. Thickness (µm): 3 | Color: Silver/Gray |
| White Corrosion (Hours), ref. ASTM B117: 6 | Salt Spray, red rust (0 to 99 hrs), ref. ASTM B117: 12 | ASTM Standard: ASTM F1941/F1941M-2016, Fe/Zn 3AN |

