

Flat Washers - Type A (Narrow) - SAE

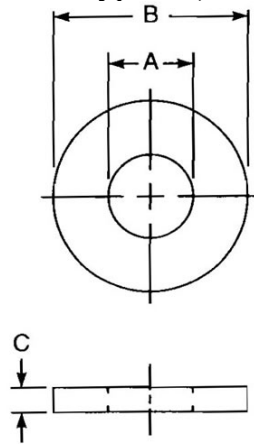

| DIMENSIONAL DATA | | |
|--|---|--|
| Type: Flat Washers - Type A (Narrow) - SAE | Standard: ASME B18.21.1-2009 | Size: #10 |
| Nominal: 0.19 | A - Inside Diameter: 0.227 - 0.214 | B - Outside Diameter: 0.515 - 0.495 |
| C - Thickness: 0.065 - 0.036 | | |
| MATERIAL DATA | | |
| Typical Material: Brass (UNS C20000-C29999) | | |
| FINISH DATA | | |
| Finish Type: Plain | K factor (ref. DIN 946): 0.2 | RoHS/REACH Compliant: yes |
| Color: colorless | | |

