

Flat Washers - Type A (Narrow) - SAE

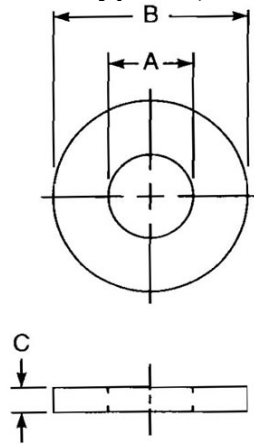

DIMENSIONAL DATA		
Type: Flat Washers - Type A (Narrow) - SAE	Standard: ASME B18.21.1-2009	Size: 3/4
Nominal: 0.75	A - Inside Diameter: 0.842 - 0.805	B - Outside Diameter: 1.499 - 1.462
C - Thickness: 0.160 - 0.108		
MATERIAL DATA		
Typical Material: Brass (UNS C20000-C29999)		
FINISH DATA		
Finish Type: Plain	K factor (ref. DIN 946): 0.2	RoHS/REACH Compliant: yes
Color: colorless		

