

# Flat Washers - Type A (Narrow) - SAE

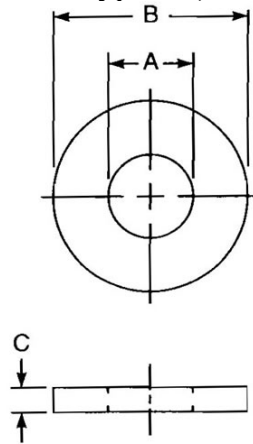

DIMENSIONAL DATA		
Type: Flat Washers - Type A (Narrow) - SAE	Standard: ASME B18.21.1-2009	Size: 3/8
Nominal: 0.375	A - Inside Diameter: 0.421 - 0.401	B - Outside Diameter: 0.827 - 0.805
C - Thickness: 0.080 - 0.051		
MATERIAL DATA		
Typical Material: Brass (UNS C20000-C29999)		
FINISH DATA		
Finish Type: Plain	K factor (ref. DIN 946): 0.2	RoHS/REACH Compliant: yes
Color: colorless		

