

# Flat Washers - Type A (Narrow) - SAE

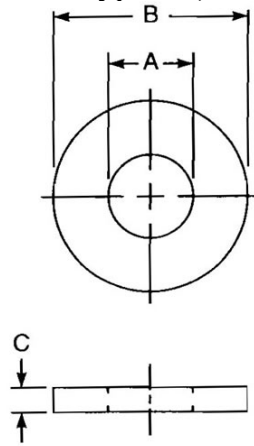

DIMENSIONAL DATA		
<b>Type:</b> Flat Washers - Type A (Narrow) - SAE	<b>Standard:</b> ASME B18.21.1-2009	<b>Size:</b> 5/8
<b>Nominal:</b> 0.625	<b>A - Inside Diameter:</b> 0.686 - 0.649	<b>B - Outside Diameter:</b> 1.342 - 1.305
<b>C - Thickness:</b> 0.121 - 0.074		
MATERIAL DATA		
<b>Typical Material:</b> Brass (UNS C20000-C29999)		
FINISH DATA		
<b>Finish Type:</b> Plain	<b>K factor (ref. DIN 946):</b> 0.2	<b>RoHS/REACH Compliant:</b> yes
<b>Color:</b> colorless		

