

Flat Washers - Type A (Narrow) - SAE

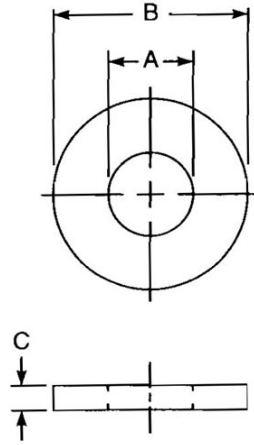

DIMENSIONAL DATA		
Type: Flat Washers - Type A (Narrow) - SAE	Standard: ASME B18.21.1-2009	Size: 3/4
Nominal: 0.75	A - Inside Diameter: 0.842 - 0.805	B - Outside Diameter: 1.499 - 1.462
C - Thickness: 0.160 - 0.108		
MATERIAL DATA		
Typical Material: Stainless steel, 18-8 (301 - 305)	Hardness: no requirement	
FINISH DATA		
Finish Type: As received steel	K factor (ref. DIN 946): 0.2	RoHS/REACH Compliant: yes
Max. Thickness (µm): 3	Salt Spray, red rust (0 to 99 hrs), ref. ASTM B117: <1	

