

# Flat Washers - Type A (Narrow) - SAE

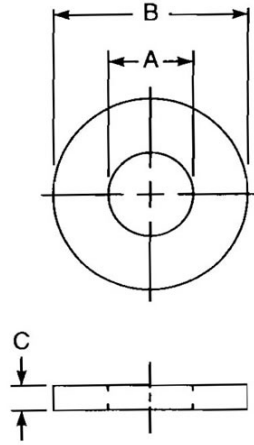

DIMENSIONAL DATA		
<b>Type:</b> Flat Washers - Type A (Narrow) - SAE	<b>Standard:</b> ASME B18.21.1-2009	<b>Size:</b> 5/16
<b>Nominal:</b> 0.312	<b>A - Inside Diameter:</b> 0.359 - 0.339	<b>B - Outside Diameter:</b> 0.703 - 0.681
<b>C - Thickness:</b> 0.080 - 0.051		
MATERIAL DATA		
<b>Typical Material:</b> Stainless steel, 18-8 (301 - 305)	<b>Hardness:</b> no requirement	
FINISH DATA		
<b>Finish Type:</b> As received steel	<b>K factor (ref. DIN 946):</b> 0.2	<b>RoHS/REACH Compliant:</b> yes
<b>Max. Thickness (µm):</b> 3	<b>Salt Spray, red rust (0 to 99 hrs), ref. ASTM B117:</b> <1	

