

Indented Hex Washer Head - Type I (Phillips) - Combination Sltd - A, AB

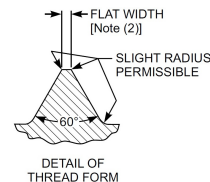

THREAD DATA		
Size: #8	Threads per in.: 18	Thread Class or Type: AB
Major Diameter: 0.1660 - 0.1590	Minor Dia Max/Min.: 0.122 - 0.116	Standard: ASME B18.6.3-2013
DIMENSIONAL DATA		
Type: Indented Hex Washer Head - Type I (Phillips) - Combination Sltd - A, AB	Standard: ASME B18.6.3 - 2013	Nominal Diameter: 0.164
H - Head Height: 0.110 - 0.096	J - Slot Width: 0.054 - 0.045	T - Slot Depth: 0.074 - 0.048
Driver Size: 2	Penetration Depth: 0.115 - 0.090	Wobble: 12°
F - Protrusion Height: 0.058 Min	G - Gage Diameter: 0.272	A - Hex AF: 0.250 - 0.244
W - Hex AC: 0.272 Min	B - Washer Diameter: 0.348 - 0.322	U - Washer Thickness: 0.031 - 0.019
M - Ref. Recess Dim.: 0.168	L - Length: 2-1/2	Length Tolerance: ± 0.05
PHYSICAL REQUIREMENTS		
Nominal: 0.164	Standard: ASME B18.6.3-2013, Type AB (carbon steel)	Typical Materials: carbon steel: 1018-1022
Test Plate Thickness in.: 0.0770 - 0.0730	Test Plate Hole Size in.: 0.1360	Torsional Strength, Min. (in.lbf): 39
Core Hardness: HRC 28 - 38	Case Hardness: HRC 45 Min.	Case Depth (in.): .009-.004
Ductility Test Angle: 10°	Straightness Factor: 0.015	
FINISH DATA		
Finish: Zinc & Clear, non-hexavalent/Cr(VI) free - .0001"/ 3µm	K factor (ref. DIN 946): 0.22	Standard: ASTM F1941/F1941M-2016, Fe/Zn 3AN

² Calculated Pretension is equal to 75% of the bolt's yield strength achieved when using the indicated Tightening Torque.

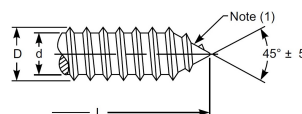
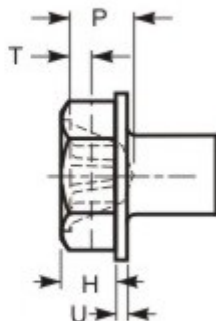
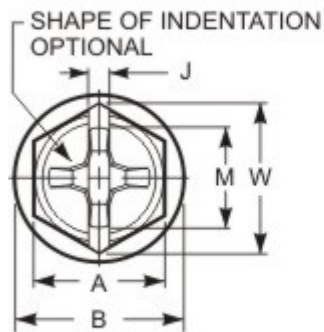